

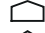



LD921_15-Z01-S03_2 
 LD921_30-Z01-S03_2 

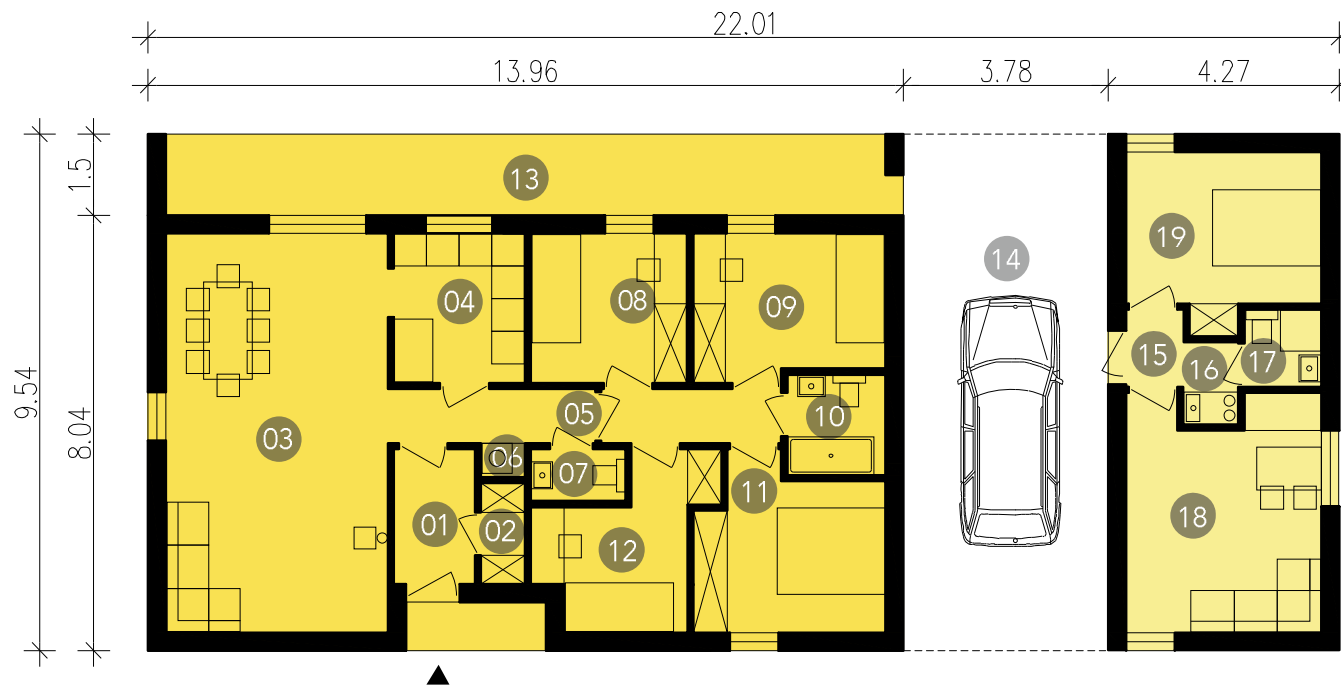

LD921_15-Z01-S03_2
LD921_30-Z01-S03_2

This basic module is supplemented with a carport for parking a car and storing bicycles and a studio ideal for grown up child or a senior. Beams in the carport provide extra space ideal for storing sports equipment.

01.hallway 3.7m²/ 02.cloakroom 1.5m²/ 03.dining room and living room 30.2m²/
04.kitchen 6.7m²/ 05.corridor 7.2m²/ 06.laundry room/boiler room 0.5m²/ 07.toilet
1.6m²/ 08.single bedroom 8m²/ 09.single bedroom 7.9m²/ 10.Bathroom 3.3m²/
11.double bedroom 10.1m²/ 12.single bedroom 7.9m²/ 13.terrace 20m²/
14.carport 36m²/ 15.hallway 1.5m²/ 16.kitchen 2.1m²/ 17.bathroom 2m²/
18.dining room and living room 15.1m²/ 19.double bedroom 10.6m²

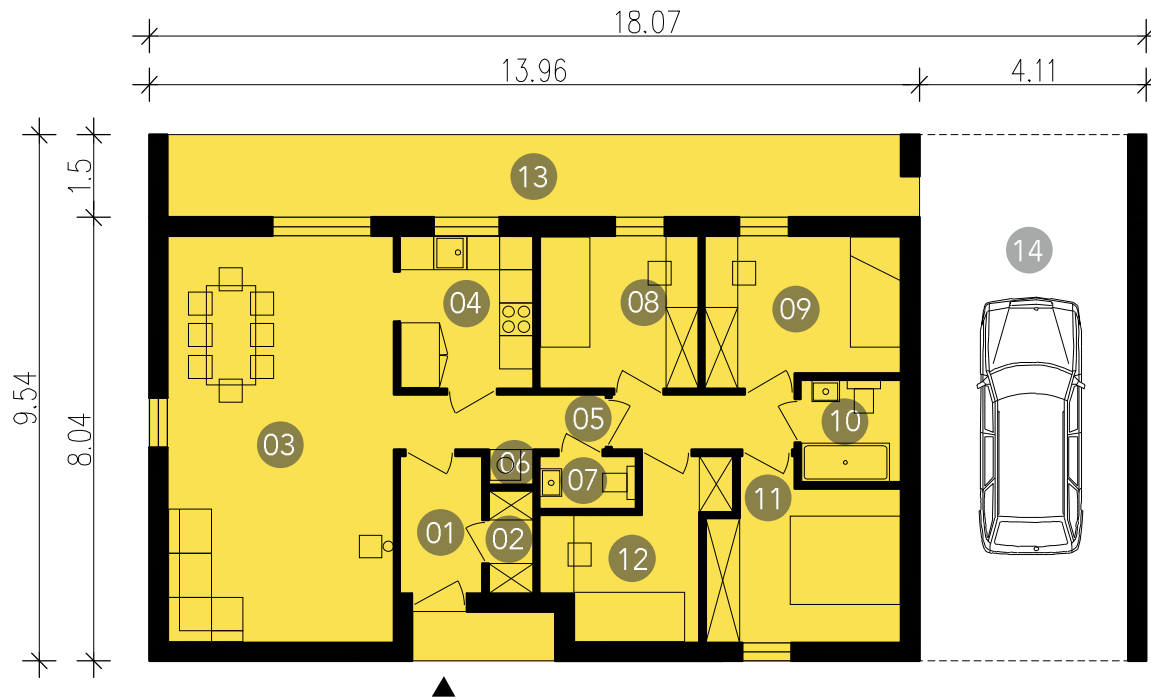

LD921_15-W02 
LD921_30-W02 



LD921_15-W02
LD921_30-W02

This basic module is supplemented with a carport for parking a car and storing bicycles and a storage room for tools. Between the storage room and the house there is an entrance going through the garden. Beams in the carport provide extra space ideal for storing sports equipment.

01.hallway 3.7m²/ **02.**cloakroom 1.5m²/ **03.**dining room and living room 30.2m²/ **04.**ktchen 6.7m²/ **05.**corridor 7.2m²/ **06.**laundry room/boiler room 0.5m²/ **07.**toilet 1.6m²/ **08.**single bedroom 8m²/ **09.**single bedroom 7.9m²/ **10.**Bathroom 3.3m²/ **11.**double bedroom 10.1m²/ **12.**single bedroom 7.9m²/ **13.**terrace 20m²/ **14.**carport 36m²

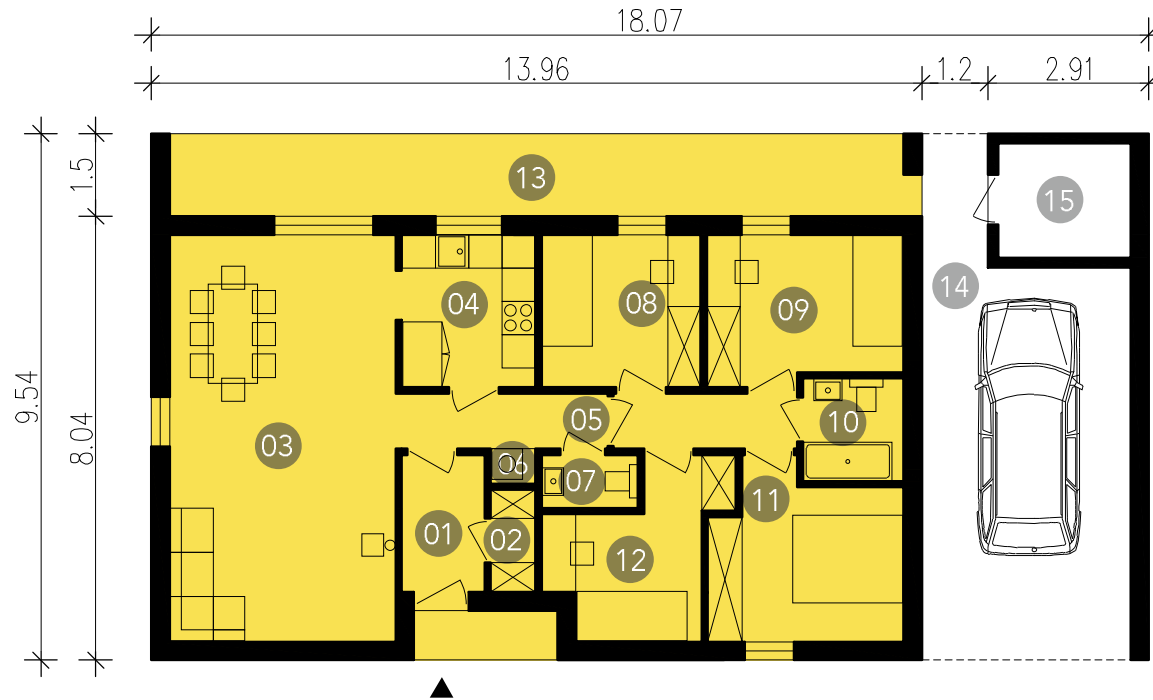

LD921_15-W01 
LD921_30-W01 



LD921_15-W01
LD921_30-W01

This basic module is supplemented with a carport for parking a car and storing bicycles and a storage room for tools. Between the storage room and the house there is an entrance going through the garden. Beams in the carport provide extra space ideal for storing sports equipment.

01.hallway 3.7m²/ **02.**cloakroom 1.5m²/ **03.**dining room and living room 30.2m²/ **04.**ktchen 6.7m²/ **05.**corridor 7.2m²/ **06.**laundry room/boiler room 0.5m²/ **07.**toilet 1.6m²/ **08.**single bedroom 8m²/ **09.**single bedroom 7.9m²/ **13.**Terrace 20m²/ **14.**Carport 29.7m²/ **15.**garden storage 4.9m²

LD921_15 
LD921_30 

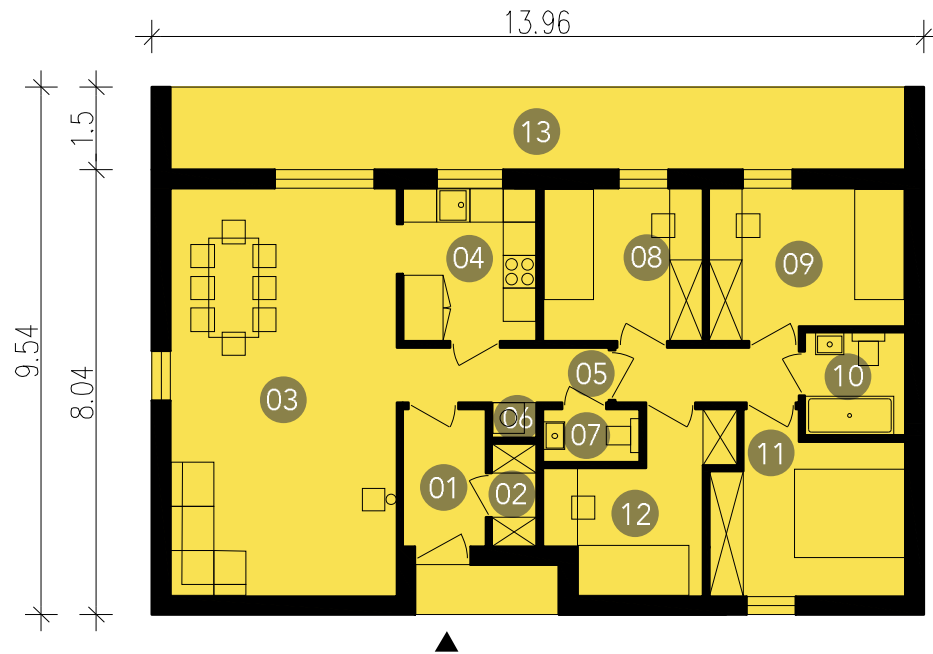

LD921_15 LD921_30

This basic module allows you to effectively arrange five rooms with kitchen giving a comfortable living space for a family. There is a separate unit which can serve as a home office or a guest house. The elements “hollowed” in the block such as roofed entrance and deck are finished with wood.

01.hallway 3.7m²/ **02.**cloak room 1.5m²/ **03.**dining room and living room 30.2m²/
04.Kitchen 6.7m²/ **05.**corridor 7.2m²/ **06.**Laundry room/boiler room 0.5m²/ **07.**Toilet
1.7m²/ **08.**single bedroom 8m²/ **09.**single bedroom 9.3m²/ **10.**bathroom 3.3m²/
11.double bedroom 10.1m²/ **12.**single bedroom 7.9m²/ **13.**terrace 20.2m²