

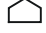

LD751_15-Z01-S03_2 
LD751_30-Z01-S03_2 

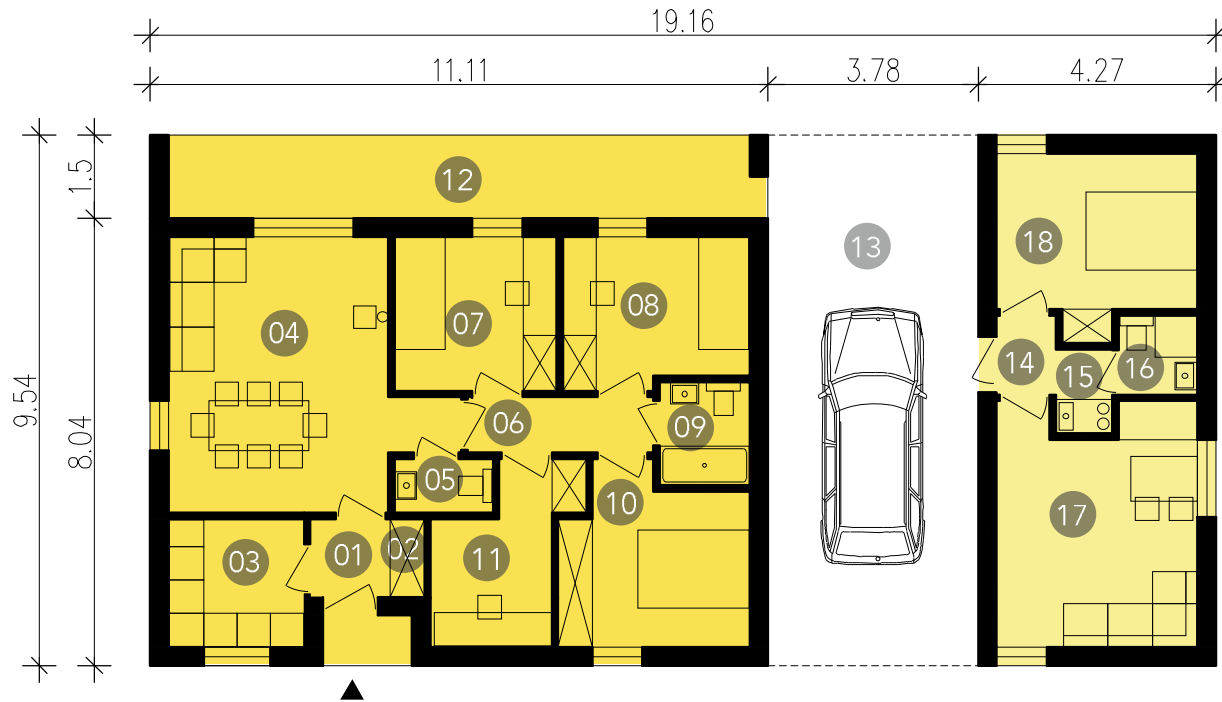

LD751_15-Z01-S03_2
LD751_30-Z01-S03_2

This basic module is supplemented with a carport for parking a car and storing bicycles and a residential studio suitable for grown up child or a senior. Beams in the carport provide extra space ideal for storing sports equipment.

01.hallway 2.2m²/ 02.boiler room 0.8m²/ 03.kitchen/laundry room 5.5m²/ 04.dining room and living room 19.6m²/ 05.Toilet 1.7m²/ 06.corridor 4.7m²/ 07.Single bedroom 8m²/ 08.Single bedroom 8.8m²/ 09.bathroom 3m²/ 10.double bedroom 10m²/ 11.room 6.6m²/ 12.terrace 15.6m²/ 13.carport 36m²/ 14.hallway 1.5m²/ 15.Kitchen annex 1.5m²/ 16.bathroom 2m²/ 17.Dining room and living room 15.1m²/ 18.double bedroom 10.6m²

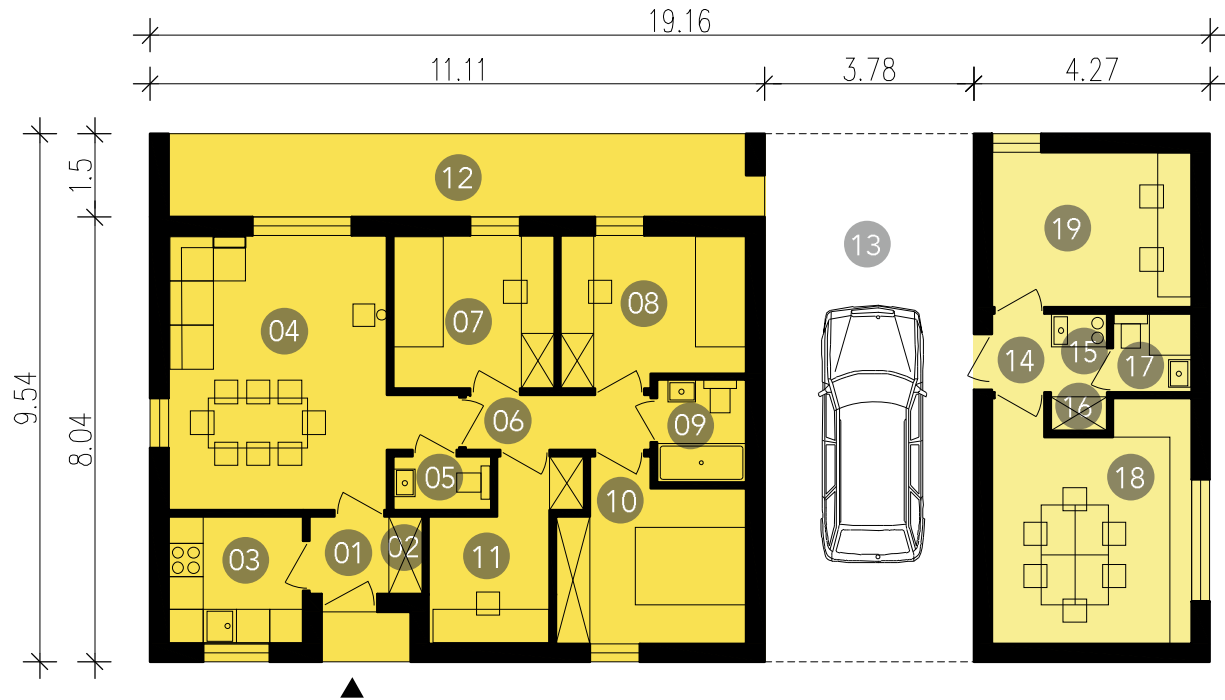

LD751_15-Z01-S03_1 
LD751_30-Z01-S03_1 



LD751_15-Z01-S03_1
LD751_30-Z01-S03_1

This basic module is supplemented with a carport for parking a car and storing bicycles. Beams in the carport provide extra space ideal for storing sports equipment.

01.hallway 2.2m²/ 02.boiler room 0.8m²/ 03.kitchen/laundry room 5.5m²/ 04.dining room and living room 19.6m²/ 05.Toilet 1.7m²/ 06.corridor 4.7m²/ 07.Single bedroom 8m²/ 08.Single bedroom 8.8m²/ 09.bathroom 3m²/ 10.double bedroom 10m²/ 11.room 6.6m²/ 12.terrace 15.6m²/ 13.carport 36m²/ 14.hallway 1.5m²/ 15.Kitchen annex 1.5m²/ 16.Pantry 0.6m²/ 17.Bathroom 2m²/ 18.office 15.1m²/ 19.study 10.1m²

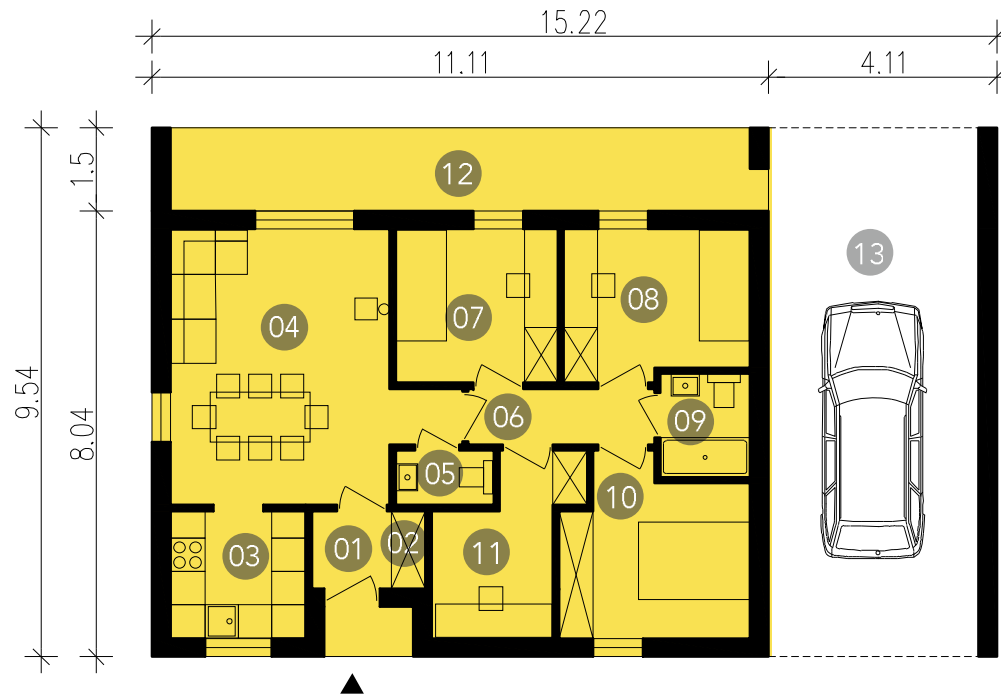

LD751_15-W02 
LD751_30-W02 



LD751_15-W02
LD751_30-W02

This basic module is supplemented with a carport for parking a car and storing bicycles. Beams in the carport provide extra space ideal for storing sports equipment.

**01.hallway 2m²/ 02.boiler room 0.8m²/ 03.kitchen/laundry room 5.5m²/
04.dining room and living room 19.6m²/ 05.toilet 1.7m²/ 06.corridor 4.7m²/
07.Single bedroom 8.8m²/ 09.bathroom 3m²/ 10.double bedroom 10m²/
11.room 6.6m²/ 12.terrace 15.6m²/ 13.carport 36m²**

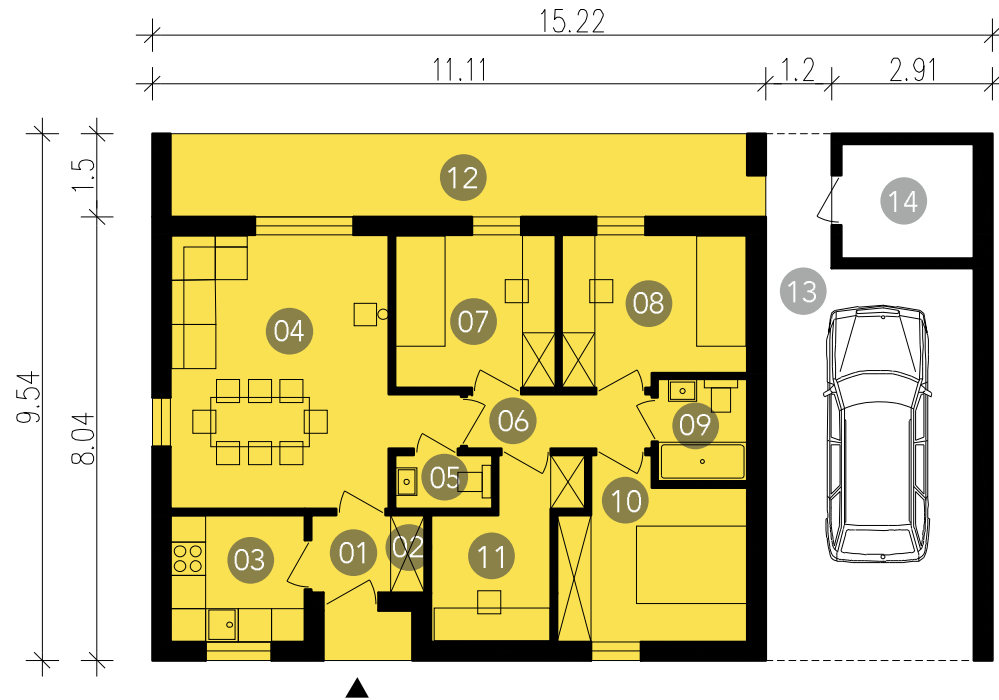

LD751_15-W01 
LD751_30-W01 



LD751_15-W01 LD751_30-W01

This basic module is supplemented with a carport for parking a car and storing bicycles and a storage room for tools. Between the storage room and the house there is an entrance going through the garden. Beams in the carport provide extra space ideal for storing sports equipment.

01.hallway 2m²/ **02.**boiler room 0.8m²/ **03.**kitchen/laundry room 5.5m²/ **04.**dining room and living room 19.6m²/ **05.**Toilet 1.7m²/ **06.**corridor 4.7 m²/ **07.**Single bedroom 8.8m²/ **08.**single bedroom 8.8m²/ **09.**Bathroom 3m²/ **10.**double bedroom 10m²/ **11.**room 6.6m²/ **12.**terrace 15.6m²/ **13.**carport 29.7m²/ **14.**garden storage 4.9m²

LD751_15 
LD751_30 

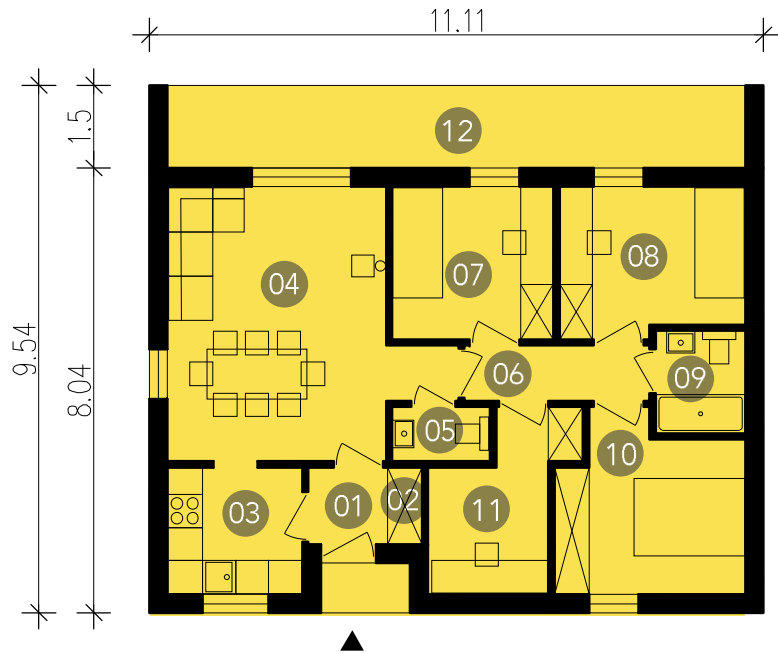

LD751_15 LD751_30

The LD751 basic module allows you to effectively arrange four rooms and the kitchen giving a comfortable living space family. The elements "hollowed" in the block such as roofed entrance and deck are finished with wooden panels.

The version with 30' roof has a possibility of converting the attic.

01.hallway 2m²/ **02.**boiler room 0.8m²/ **03.**kitchen/laundry room 5.5m²/ **04.**dining room and living room 19.6m²/ **05.**toilet 1.7m²/ **06.**corridor 4.7m²/ **07.**single bedroom 8m²/ **08.**single bedroom 8.8m²/ **09.**bathroom 3m²/ **10.**double bedroom 10m²/ **11.**room 6.6m²/ **12.**terrace 15.6m²