





LD581_15-Z01_S03_2 
 LD581_30-Z01_S03_2 

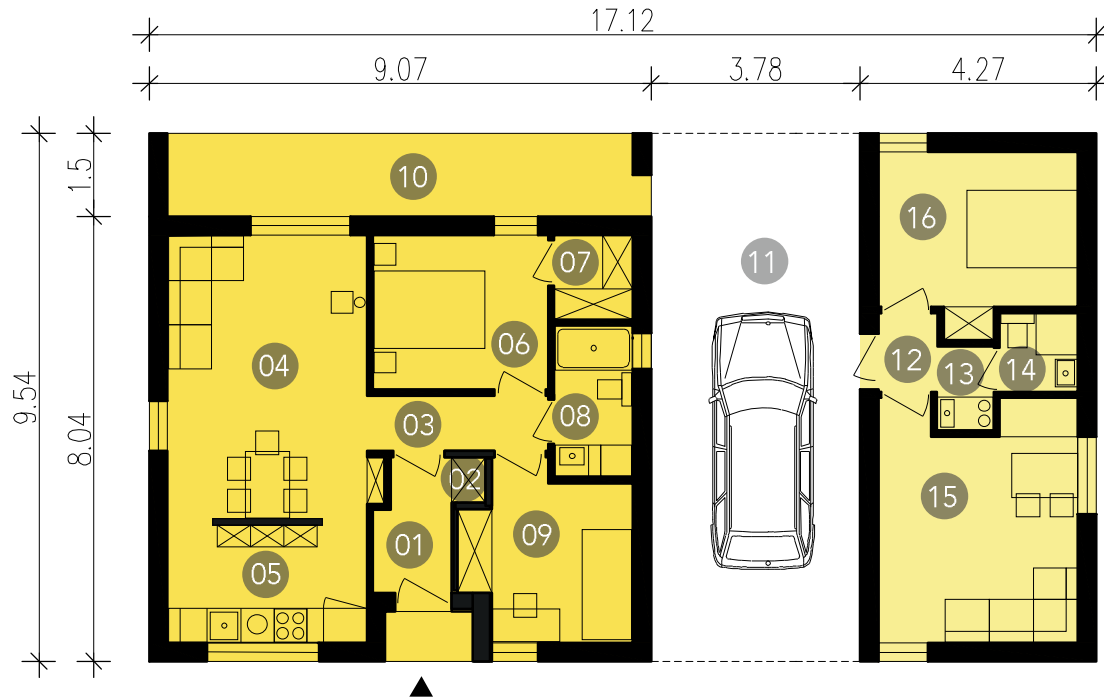

LD581_15-Z01_S03_2
LD581_30-Z01_S03_2

Basic module supplemented by carport for a car and bicycles and a studio apartment module for grown up child or senior. There is an extra storage space for sport equipment on beam constructions.

01.Hallway 3.1/ **02.**Boiler room 0.5m²/ **03.**Corridor 3.2m²/ **04.**Dining room and living room 18.9m²/ **05.**Kitchen/ laundry room 7.6m²/ **06.**Double bedroom 8.8m²/ **07.**cloakroom 2.4m²/ **08.**bathroom 3.8m²/ **09.**single bedroom 8.8m²/ **10.**terrace 12.8m²/ **11.**carport 36m²/ **12.**halway 1.5m²/ **13.**kitchen 2.1m²/ **14.**bathroom 12m²/ **15.**dining room and living room 15.1m²/ **16.**double bedroom 10.6m²

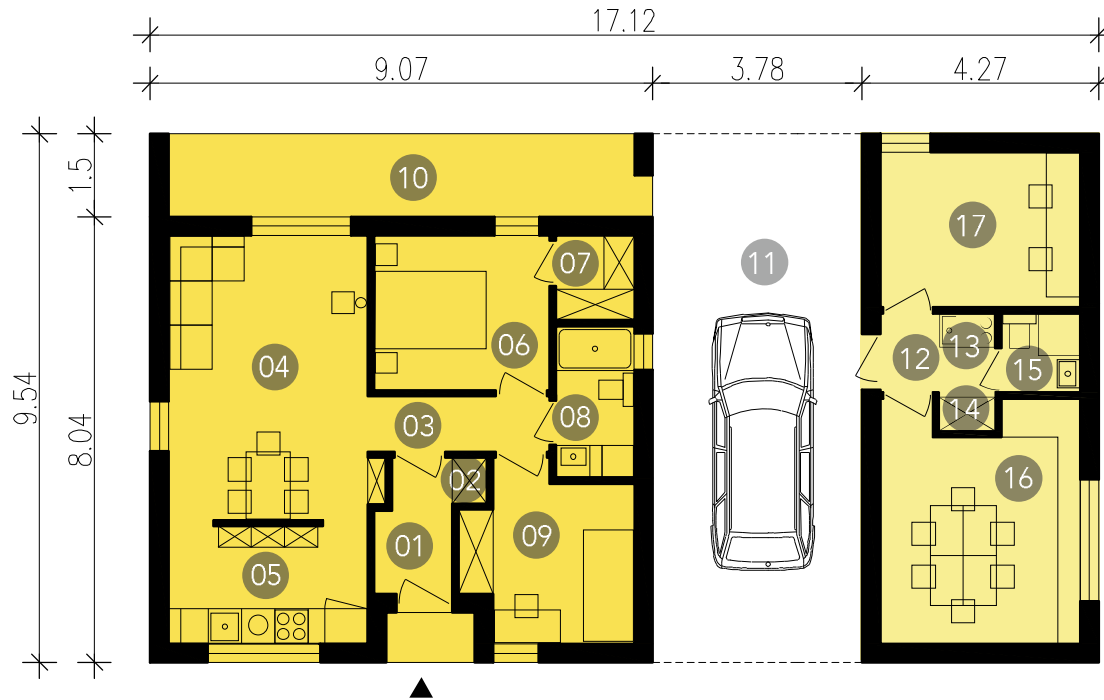

LD581_15-Z01 -S03_1 
LD581_30-Z01 -S03_1 



LD581_15-Z01 -S03_1
LD581_30-Z01 -S03_1

This basic module is supplemented with a carport for parking a car and storing bicycles and a studio. Beams in the carport provide extra space ideal for storing sports equipment.

01.hallway 3.1m²/ **02.**boiler room 0.5m²/ **03.**corridor 3.2m²/ **04.**dining room and living room 18.9m²/ **05.**Kitchen/ laundry room 7.6m²/ **06.**double bedroom 8.8m²/ **07.**Cloakroom 2.1m²/ **08.**Bathroom 3.8m²/ **09.**Single bedroom 8.8m²/ **10.**terrace 12.8m²/ **11.**Carport 36m²/ **12.**Hallway 1.5m²/ **13.**kitchen annex 1.5m²/ **14.**pantry 0.6m²/ **15.**bathroom 2m²/ **16.**office 15.1m²/ **17.**Study 10.1m²

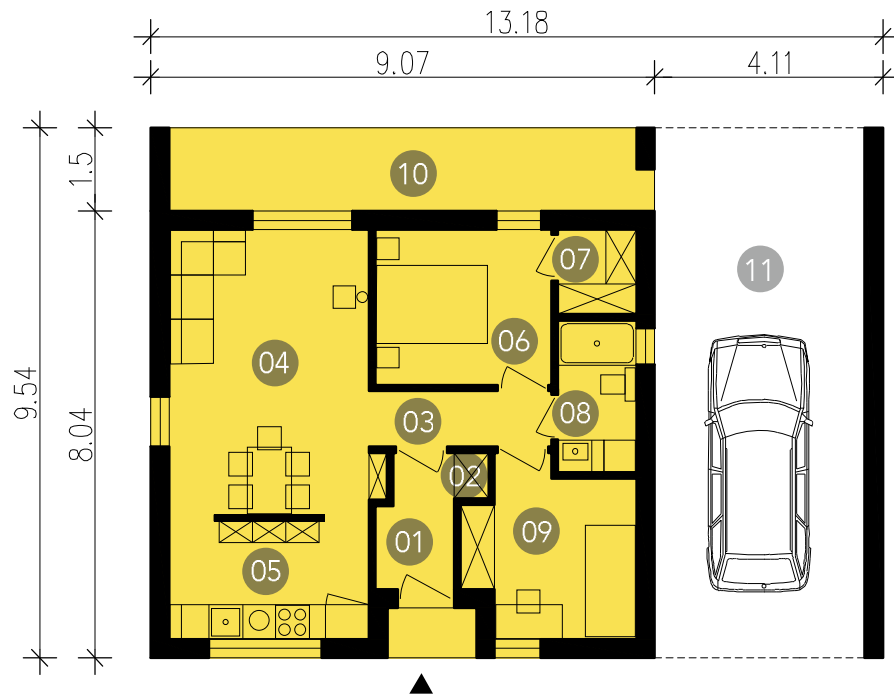

LD581_15-W02 
LD581_30-W02 



LD581_15-W02
LD581_30-W02

This basic module is supplemented with a carport for parking a car and storing bicycles and a studio. Beams in the carport provide extra space ideal for storing sports equipment.

01.hallway 3.1m²/ **02.**boiler room 0.5m²/ **03.**corridor 3.2m²/ **04.**dining room and living room 18.9m²/ **05.**Kitchen/laundry room 7.6m²/
06.double bedroom 8.8m²/ **07.**Cloakroom 2.1m²/ **08.**Bathroom 3,8m²/
09.Single bedroom 8.8m²/ **10.** terrace 12.8m²/ **11.**carport 40.9m²

LD581_15-W01 
LD581_30-W01 

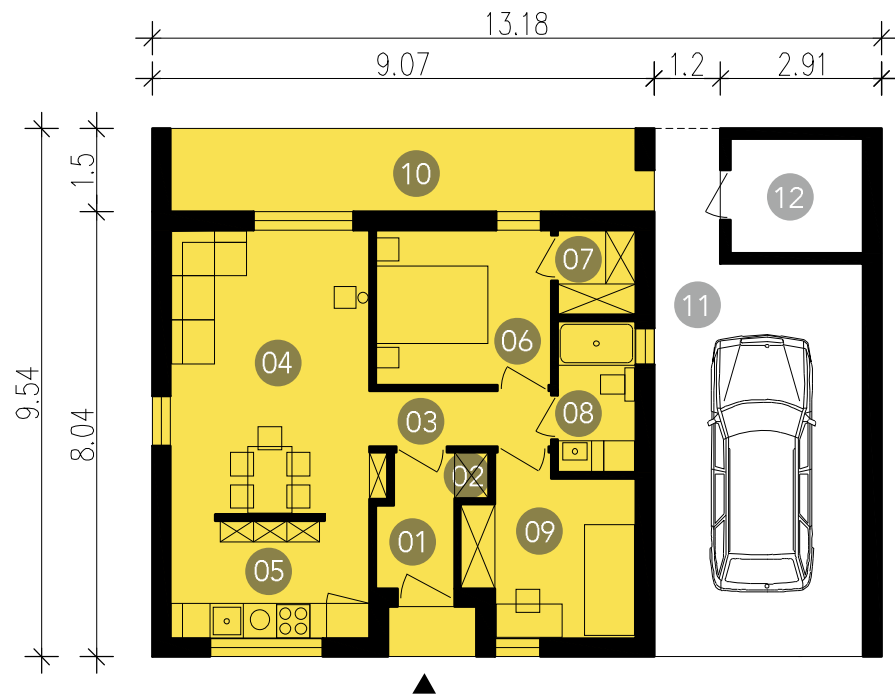

LD581_15-W01
LD581_30-W01

This basic module is supplemented with a carport for parking a car and storing bicycles and a studio. Beams in the carport provide extra space ideal for storing sports equipment.

01.hallway 3.1m²/ **02.**boiler room 0.5m²/ **03.**corridor 3.2m²/ **04.**dining room and living room 18.9m²/ **05.**Kitchen/laundry room 7.6m²/ **06.**double bedroom 8.8m²/ **07.**Cloakroom 2.1m²/ **08.**Bathroom 3,8m²/ **09.**Single bedroom 8.8m²/ **10.**terrace 12.8m²/ **11.**carport 36m²/ **12.**garden storage 4.9m²

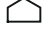
LD581_15 
LD581_30 

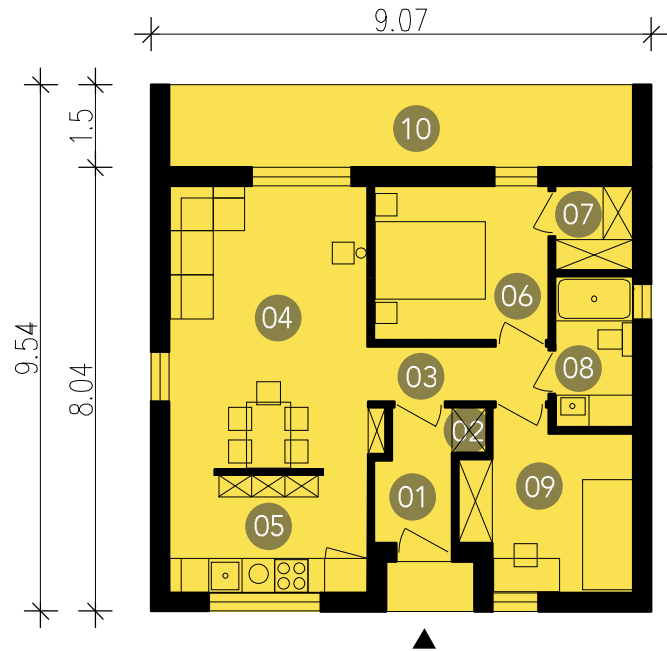

LD581_15 LD581_30

The LD581 basic module allows you to effectively arrange three rooms with kitchen giving a comfortable living space for a family of 2 + 1. This house may serve as a guest house, summer house, or with additional modules it can become a regular house. The elements "hollowed" in the block such as roofed entrance and deck are finished with wood.

The version with 30' roofs have a possibility of converting the attic.

01.hallway 3.1m²/ **02.**boiler room 0.5m²/ **03.**corridor 3.2m²/ **04.**dining room and living room 18.9m²/ **05.**Kitchen/laundry room 7.6m²/ **06.**double bedroom 8.8m²/ **07.**Cloakroom 2.1m²/ **08.**Bathroom 3.8m²/ **09.**single bedroom 8.8m²/ **10.**terrace 12.6m²