

D583_45-Z02-A02



Ground floor area: 58m²

Attic area: 28m²

Total area: 86m²

Workshop area: 26,8m²

23,28

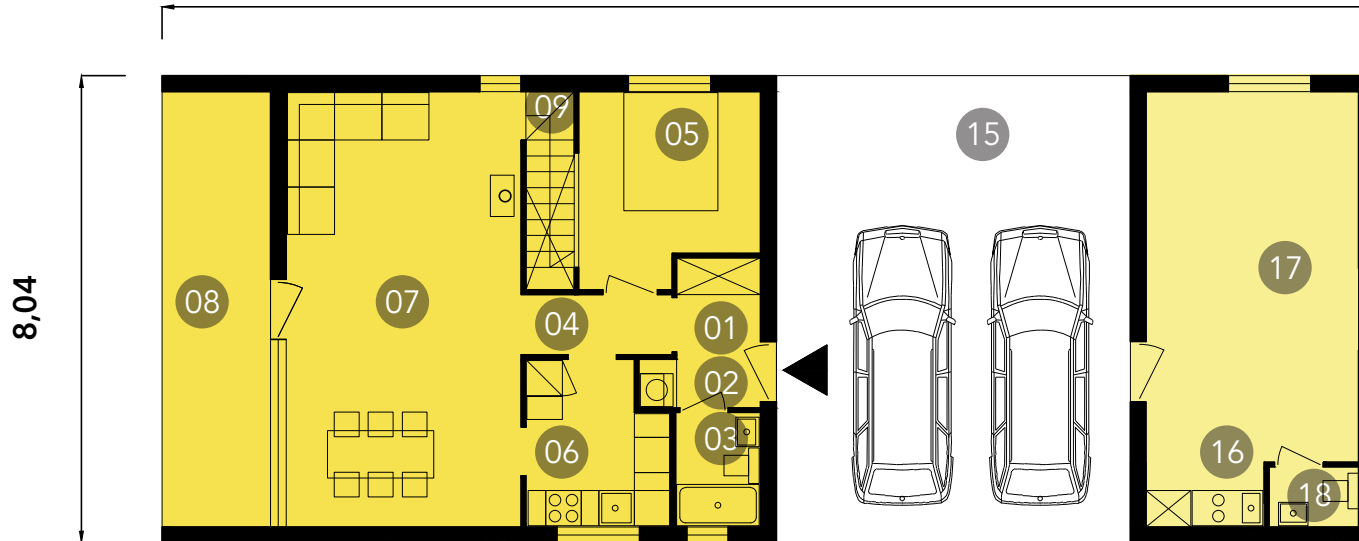

8,04

Compact house with a usable attic is suitable for a family of four. The spacious living room connected directly to the covered wooden terrace creates a comfortable sitting area. The house features a garage with a garden storage. Entering the building and garage through the carport protects from rain and gives extra storage space. The roofing over the terrace is finished with wooden decking.

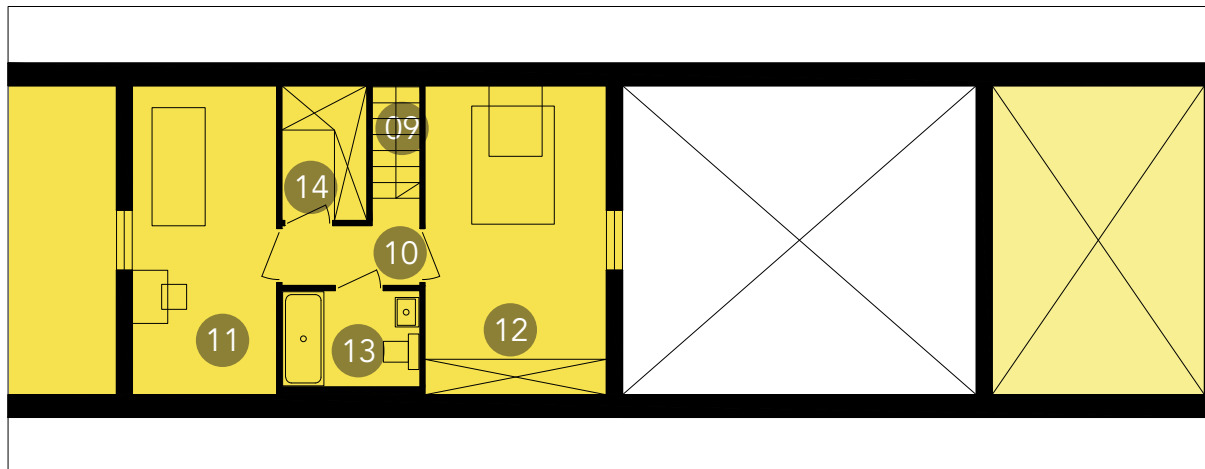

01.hallway 2.5m²/ 02.laundry room/boiler room 1.5m²/ 03.bathroom 2.8m²/ 04.corridor 2.6m²/ 05.Double bedroom 9.4m²/ 06.kitchen 6.4m²/ 07.dining room and living room 29.3m²/ 08.Terrace 18m²/ 09.Stairs 2.7m²/ 10.Stairs 2.7m²/ 11.Single bedroom 12.8m²/ 12.Double bedroom 16.1m²/ 13.bathroom 3.8m²/ 14.Cloakroom 3.3m²/ 15.Carport 47.5m²/ 16.kitchen 1.4m²/ 17.dining room/living room 22.6m²/ 18.bathroom 1.5m²

Minimum plot dimensions: 16mx20m (unless otherwise advised by zoning development plan or planning permission for a given plot)

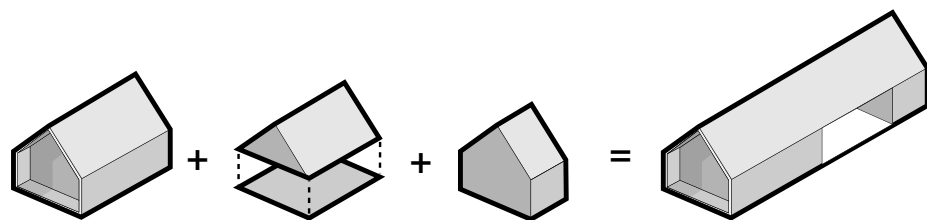

D583_45-Z02-A02

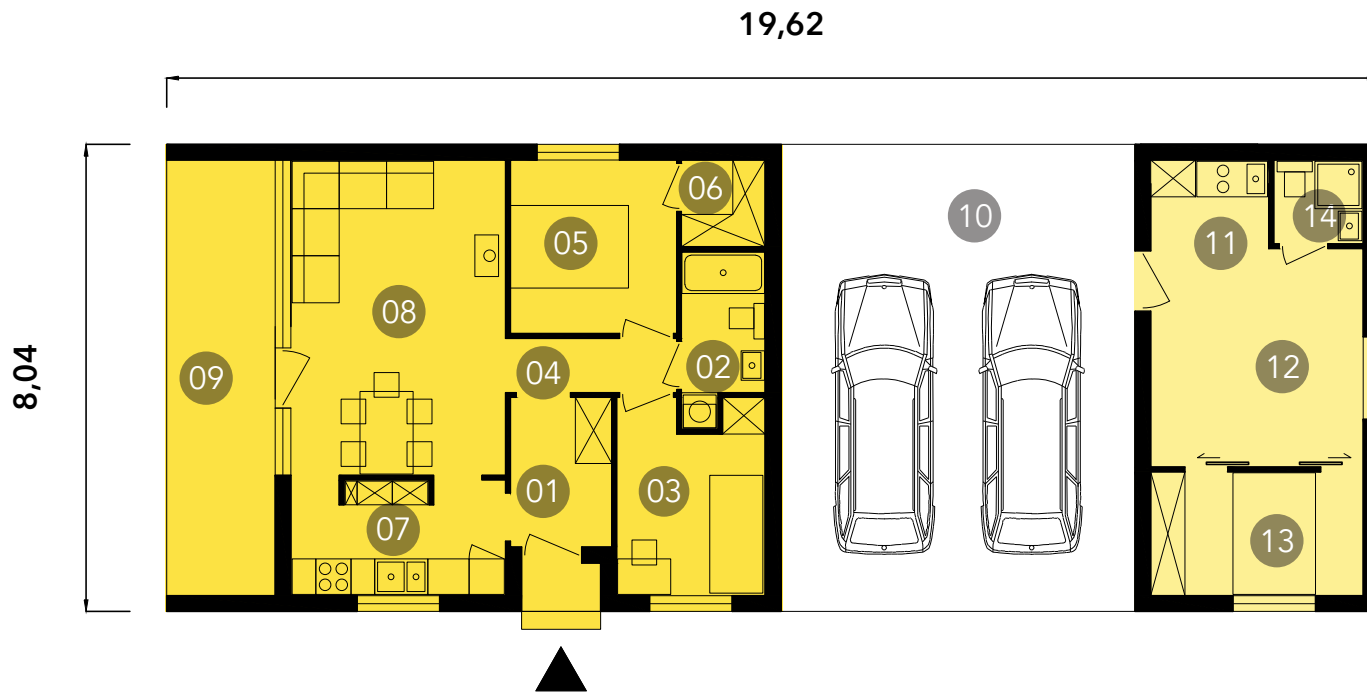

D582_15-Z02-A01
D582_30-Z02-A01
D582_45-Z02-A01



This compact house with a usable attic is suitable for a family of four. The spacious living room connected directly to the covered wooden terrace creates comfortable sitting area. The house features a garage with a garden storage. Entering the building and garage through the carport protects from rain and gives extra storage space. The roofing over the terrace is finished with wood decking.

Minimum plot dimensions: 16mx20m
(unless otherwise advised by zoning
development plan or planning permission
for a given plot)

01.hallway 4.3m²/ 02.bathroom/ laundry room / boiler room 3.7 m²/ 03.Single bedroom 8m²/
04.corridor 2.6m²/ 05.double bedroom 8.3m²/ 06.Cloakroom 2m²/ 07.Kitchen 7.2m²/ 08.dining
room and living room 19.4m²/ 09.Terrace 18m²/ 10.Carport 47.5m²/ 11.kitchen 2 2.2m²/
12.dining room 2 13.4m²/ 13.double bedroom 7.5m²/ 14.Bathroom 2 2.1m²

Configuration	2 / roof 15°	D582_15-Z02-A01	
Configuration	2 / roof 30°	D582_30-Z02-A01	
Configuration	2 / roof 45°	D582_45-Z02-A01	

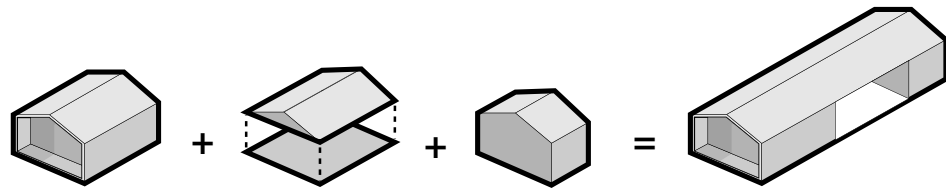

D582_15-Z02-A01

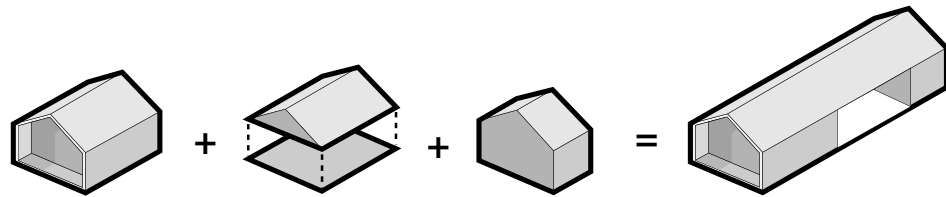

D582_30-Z02-A01

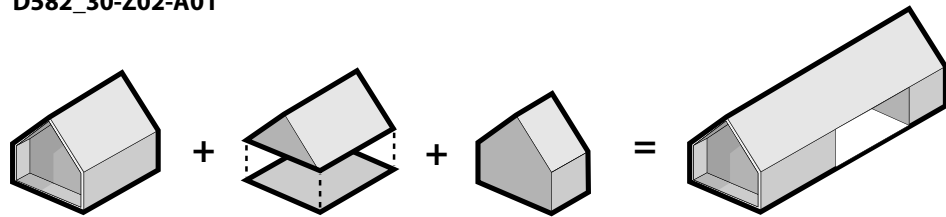

D582_45-Z02-A01

D583_45-Z01-G03



Ground floor area: 58m²

Attic area: 28m²

Total area: 86m²

Garage and storage area: 27m²

Carport area: 29m²

19,62



A compact house with a usable attic suitable for a family of four. The spacious living room connected directly to the covered wooden terrace creates comfortable sitting area. The house features a garage with a garden storage. Entering the building and the garage through the carport protects from rain and gives extra storage space. The terrace and the entrance are finished with wooden decking.

Minimum plot dimensions: 16mx20m (unless otherwise advised by zoning development plan or planning permission for a given plot)

01.hallway 2.5m²/ 02.laundry room / boiler room 1.5 m²/ 03.Bathroom 2.8m²/ 04.corridor 2.6m²/ 05.double bedroom 9.4m²/ 06.Kitchen 6.4m²/ 07.Dining room and living room 29.3m²/ 08.Terrace 13.5m²/ 09.stairs 2.7m²/ 10.Corridor 2.4m²/ 11.Single bedroom 12.8m²/ 12. double bedroom 16.1m²/ 13.Bathroom 3.8m²/ 14.Cloakroom 3.3m²/ 15.carport 28.5m²/ 16.garage 22.8m²/ garden storage 3m²

Konfiguracja 6 : D583_45-Z01-G03

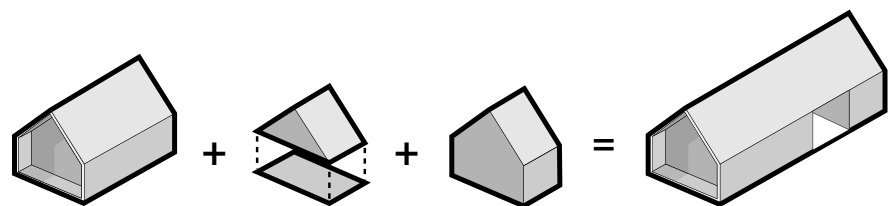

D583_45-Z01-G02

D583_45-G01 

ground floor area: 58m²

attic area: 28m²

total area: 86m²

garage and storage area: 27m²

19,15

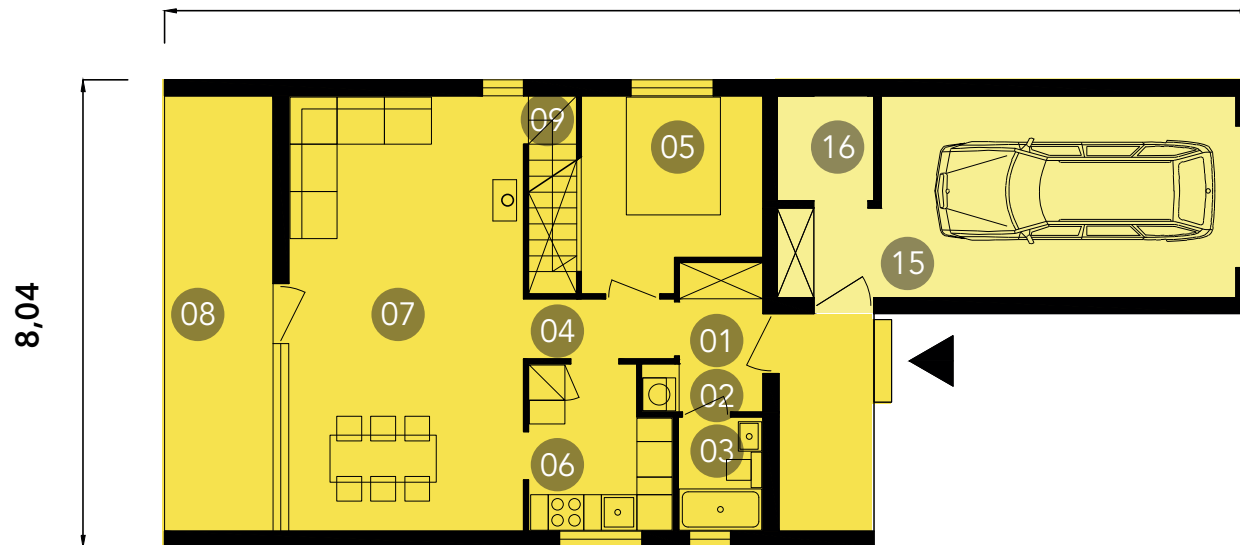

8,04

A compact house with a usable attic suitable for a family of four. The spacious living room connected directly to the covered wooden terrace creates comfortable sitting area. The house features a garage with a garden storage. Entering the building and the garage through the carport protects from rain and gives extra storage space. The terrace and the entrance are finished with wooden decking.

Minimum plot dimensions: 16mx20m (unless otherwise advised by zoning development plan or planning permission for a given plot)

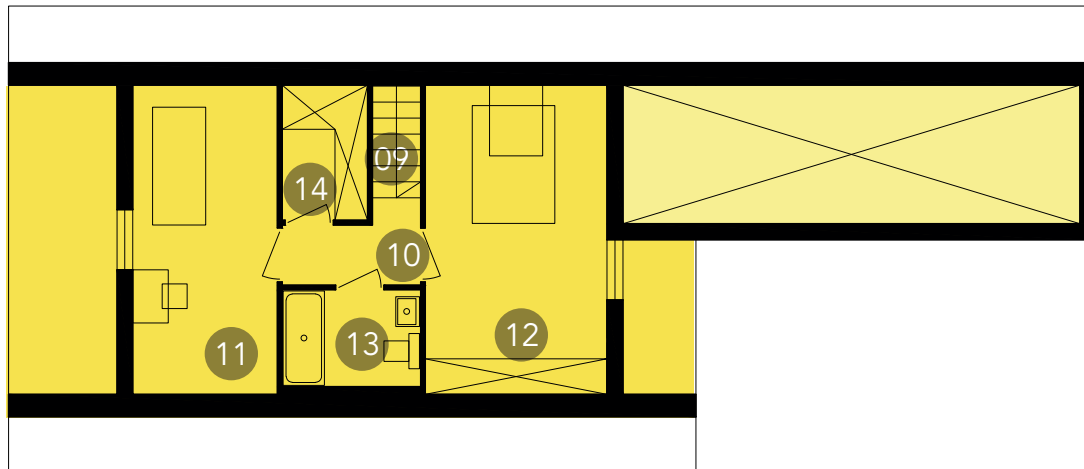

01.hallway 2.5m²/ 02.laundry room / boiler room 1.5 m²/ 03.Bathroom 2.8m²/
04.corridor 2.6m²/ 05.double bedroom 9.4m²/ 06.Kitchen 6.4m²/ 07.Dining room and
living room 29.3m²/ 08.Terrace 18m²/ 09.stairs 2.7m²/ 10.Corridor 2.4m²/ 11.Single
bedroom 12.8m²/ 12.double bedroom 16.1m²/ 13.Bathroom 3.8m²/ 14.Cloakroom
3.3m²/ 15.garage 23.2m²/ garden storage 3m²

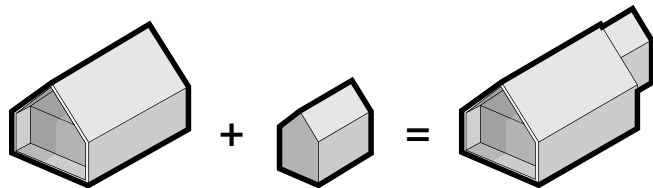

D583_45-G01

D582_15-Z01-G03
D582_30-Z01-G03
D582_45-Z01-G03



19,62

8,04

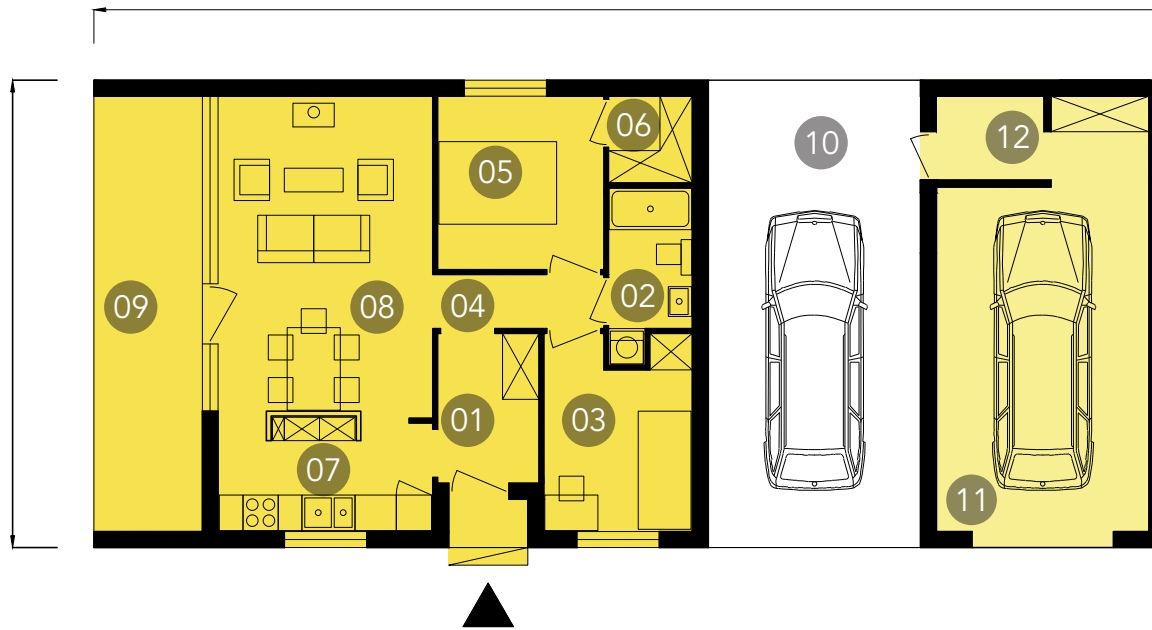

This bungalow is suitable for a family of four. It features two bedrooms and a spacious kitchen. The terrace is situated next to the living room which creates a comfortable seating area. The terrace roof is finished with wooden decking. The house has a carport above the entrance of the roof and a garage with a garden storage. Entering the building and garage through the carport protects you from rain and gives an extra storage space.

Minimum plot dimensions: 16mx20m
(unless otherwise advised by zoning
development plan or planning permission
for a given plot)

01.hallway 4.3m²/ 02.bathroom/ laundry room / boiler room 3.7m²/ 03.Single bedroom 8m²/ 04.Corridor 2.6m²/ 05.Double bedroom 8.3m²/ 06.cloakroom 2m²/ 07.kitchen 7.2m²/ 08.Dining room and living room 19.4m²/ 09.Terrace 18m²/ 10.Carport 29m²/ 11.garage 23.2m²/ 12.garden storage 2.7m²

Configuration 2 / roof 15°
Configuration 2 / roof 30°
Configuration 2 / roof 45°

D582_15-Z01-G03
D582_30-Z01-G03
D582_45-Z01-G03

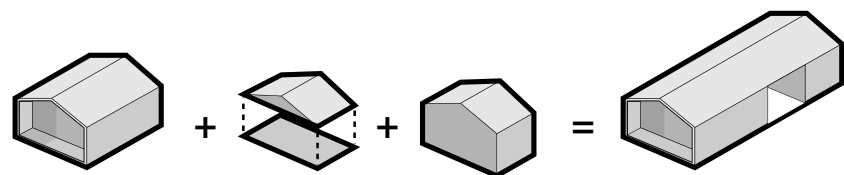

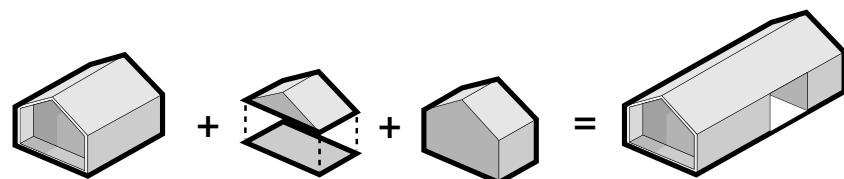

D582_15-Z01-G03

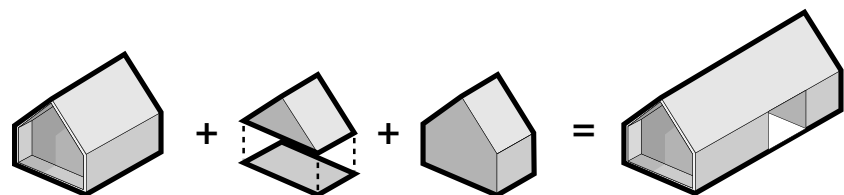

D582_30-Z01-G03

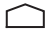

D582_45-Z01-G03

D582_15-G02 
D582_30-G02 
D582_45-G02 



Compact two-bedroom bungalow with a living room and a spacious kitchen. The terrace is situated next to the living room which creates a comfortable seating area. The garage is attached to the house. The terrace roof and the entrance niche is finished with wooden decking.

Minimum plot dimensions: 16mx20m (unless otherwise advised by zoning development plan or planning permission for a given plot)

01.hallway 4.3m²/ 02.bathroom/ laundry room / boiler room 3.7m²/ 03.Single bedroom 8m²/
04.Corridor 2.6m²/ 05.Double bedroom 8.3m²/ 06.cloakroom 2m²/ 07.kitchen 7.2m²/ 08.Dining
room and living room 19.4m²/ 09.Terrace 18m²/ 10.garage 22.8m²/ 11.garden storage 3m²

Configuration 2 / roof 15°
Configuration 2 / roof 30°
Configuration 2 / roof 45°

D582_15-G02
D582_30-G02
D582_45-G02

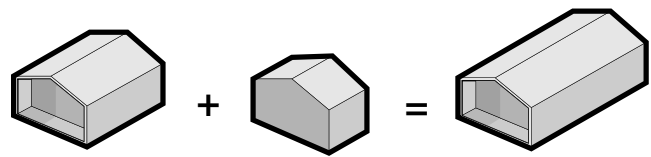
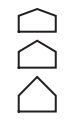

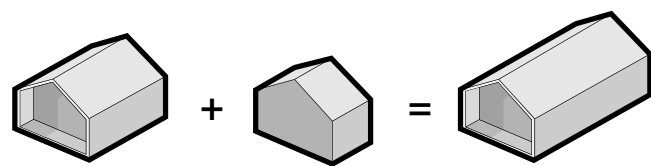

D582_15-G02

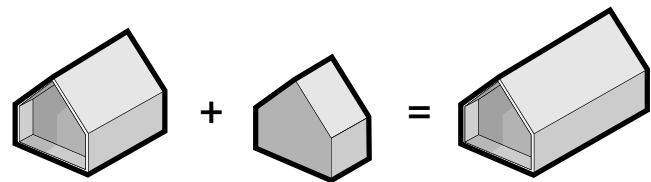

D582_30-G02

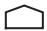

D582_45-G02

- D581_15-Z01-G03 
- D581_30-Z01-G03 
- D581_45-Z01-G03 

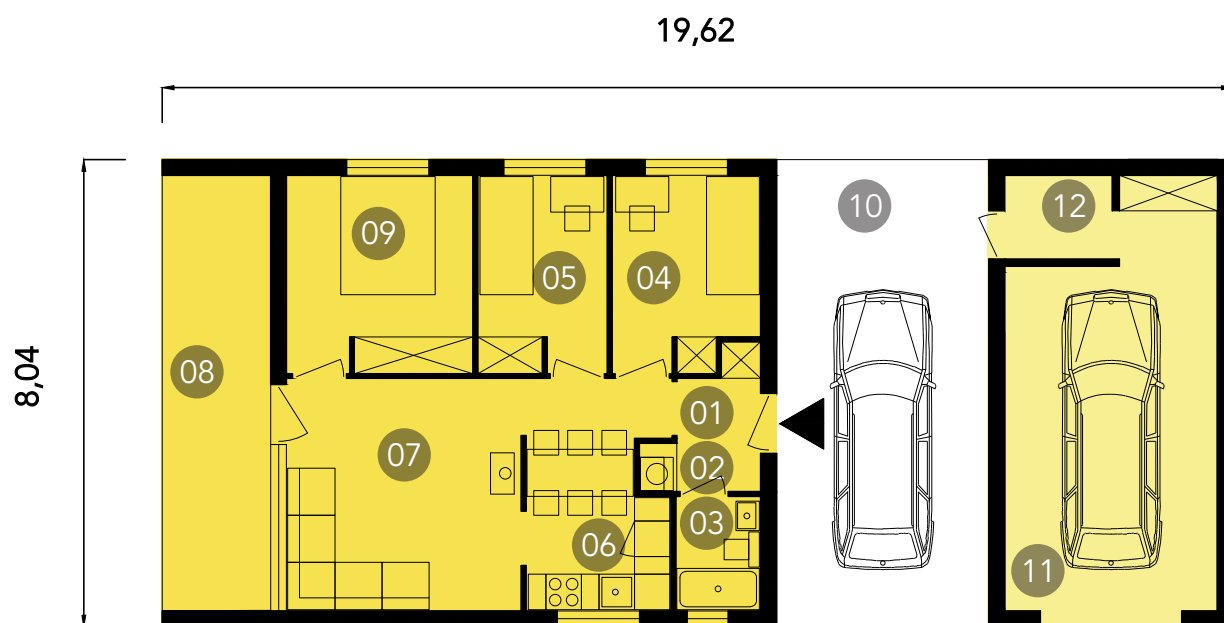



It's a compact bungalow ideal for a family of four. The house has 3 separate bedrooms and an open space living room and a kitchen annex. The terrace in the immediate vicinity of the living room creates a comfortable seating area. On the entrance side there is a garage with a garden storage. Entering the building and the garage through the roofing protects from rain and provides additional storage space for trolleys and bicycles. Roofing from the terrace side is finished with wooden decking

Minimum plot dimensions: 16mx20m (unless otherwise advised by zoning development planning or planning permission for a given plot)

01.hallway 2.1m²/ 02.laundry room / boiler room 1.5m²/ 03.bathroom 2.8 m²/ 04.Single bedroom 8m²/ 05.Single bedroom 7.4m²/ 06.kitchen 4.2m²/ 07.dining room and living room 20.1m² / 08.terrace. 18m²/ 09.double bedroom 10.5m²/ 10.Carport 29m²/ 11.garage 23.2m²/ 12.garden storage 2,7m²

Configuration 2 / roof 15°
Configuration 2 / roof 30°
Configuration 2 / roof 45°

D581_15-Z01-G03 
D581_30-Z01-G03 
D581_45-Z01-G03 

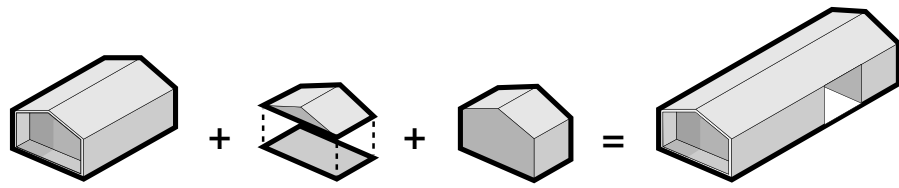

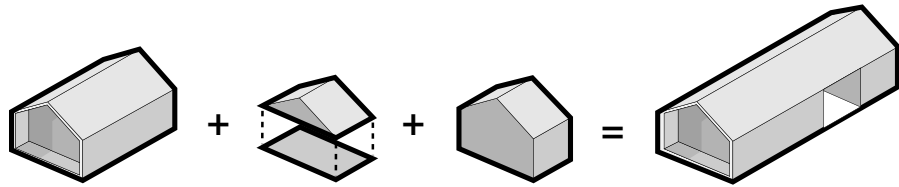

D581_15-Z01-G03

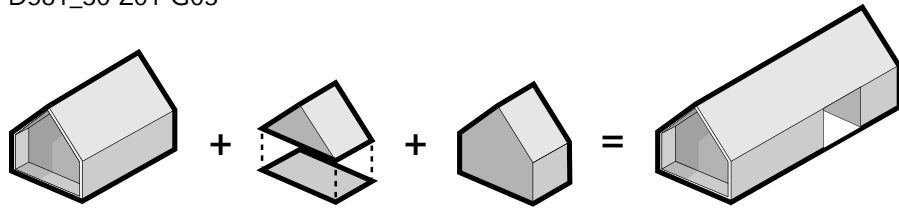

D581_30-Z01-G03



D581_45-Z01-G03

D581_15-G01 
 D581_30-G01 
 D581_45-G01 

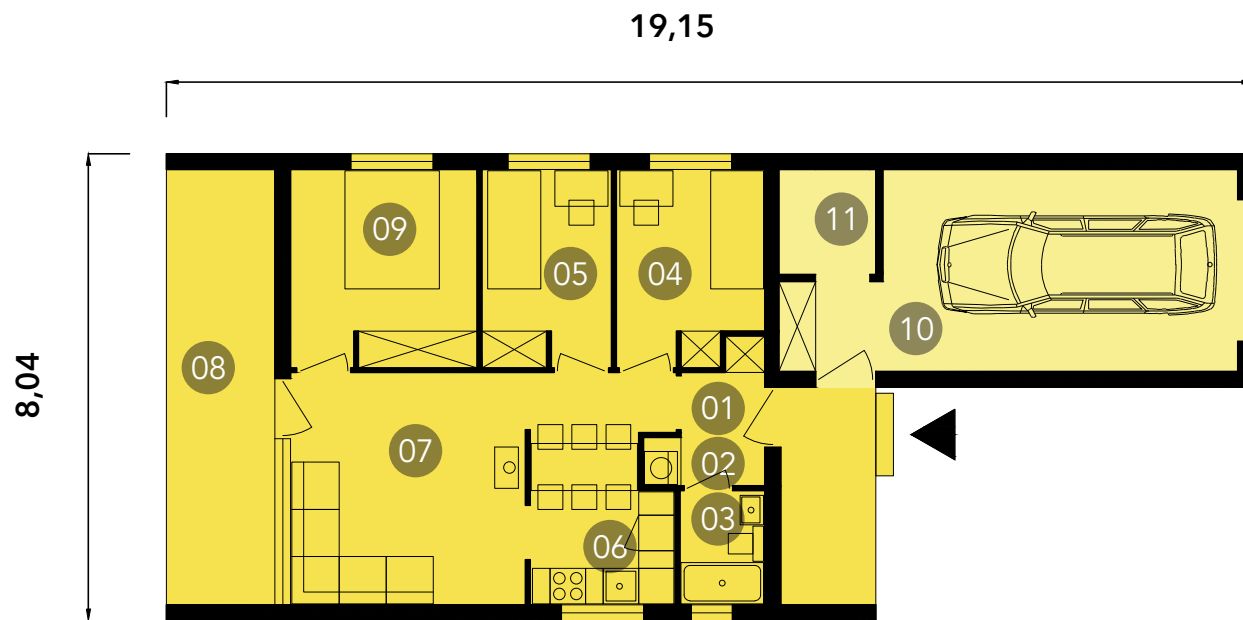

It's a compact bungalow providing the minimum necessary comfort for a family of four. It has the possibility of being implemented in three technological standards as simple, energy efficient or passive. The house has 3 separate bedrooms and an open space living room and a kitchen annex. The terrace is situated next to the living room which creates a comfortable seating area. On the entrance side there is a garage with a garden storage. Entering the building and the garage through the roofing protects from rain and provides additional storage space for trolleys and bicycles.

Minimum plot dimensions: 16mx20m (unless otherwise advised by zoning development planning or planning permission for a given plot)

01.hallway 2.1m²/ **02.**laundry room / boiler room 1.5m²/ **03.**bathroom 2.8 m²/ **04.**Single bedroom 8m²/ **05.**Single bedroom 7.4m²/ **06.**kitchen 4.2m²/ **07.**dining room and living room 20.1m²/ **08.**terrace. 18m²/ **09.**double bedroom 10.5m²/ **10.**garage 23.2m²/ **11.**garden storage 3m²

Konfiguracja 1 / dach 15°

D581_15-G01



Konfiguracja 1 / dach 30°

D581_30-G01



Konfiguracja 1 / dach 45°

D581_45-G01

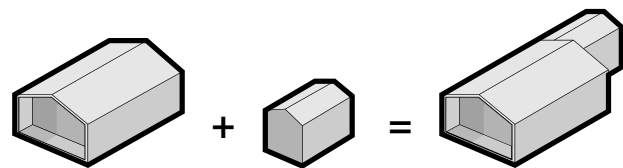

D581_15-G01

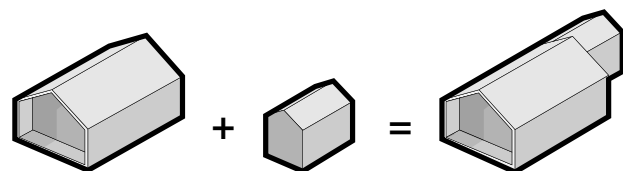

D581_30-G01

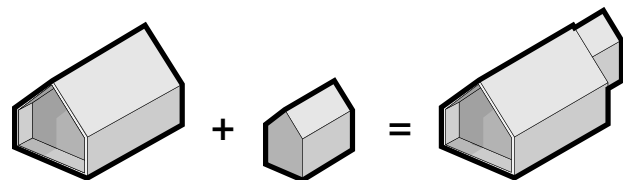

D581_45-G01

D583_45

Ground floor area: 58 m²

Attic area: 28 m²

Total area: 86 m²





D583

D583 is a compact house with a usable attic. It can be a comfortable house for a family of four. Spacious living room connected directly to the terrace creates comfortable space for recreation and relaxation. The roofing from the entrance side provides extra space for storage. The roofing is finished with wood decking.

Minimum plot dimensions: 16mx20m
(unless otherwise advised by zoning development planning or planning permission for a given plot)

01.hallway 2.5m²/ 02.laundry room / boiler room 1.5m²/ 03.bathroom 2.8 m²/ 04.Corridor 2.6m²/ 05.double bedroom 9.4m²/ 06.kitchen 6.4m²/ 07.dining room and living room 29.3m²/ 08.terrace. 13.5m²/ 09.stairs 2.7m²/ 10.corridor 2.4m²/ 11.single bedroom 12.8m²/ 12.Double bedroom 16.1m²/ 13.bathroom 3.8m²/ 14.cloakroom 3.3m²

D582_15 
D582_30 
D582_45 

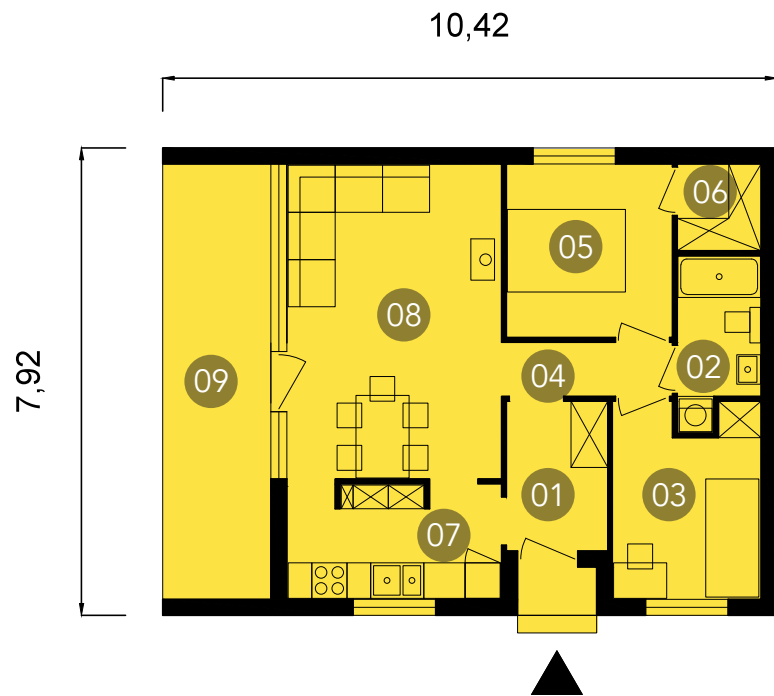



D582

D582 is a compact bungalow with two bedrooms, living room and spacious kitchen. It can be a comfortable house for a couples as well as for a family of four. The terrace is situated next to the living room which creates a comfortable seating area. The roofing from the terrace side and the entrance side is finished with wooden decking.

Minimum plot dimensions:
16mx20m (unless otherwise
advised by zoning development
planning or planning permission
for a given plot)

01.hallway 4.3m²/ **02.**Bathroom/laundry room / boiler room 3.7m²/ **03.**single bedroom 8 m²/ **04.**Corridor 2.6m²/ **05.**double bedroom 8.3m²/ **06.**cloakroom 2m²/ **07.**kitchen 7.2m²/ **08.**dining room and living room 19.4m²/ **09.**terrace 13.5m²

D581_15 
 D581_30 
 D581_45 



D581

D 581 is a compact, low-cost wooden bungalow . It provides the necessary minimum comfort for up to four people. The house has 3 separate bedrooms and an open space living room and a kitchen annex. The terrace is situated next to the living room which creates a comfortable seating area. The roofing from the terrace side and the entrance is finished with wood decking. The house is built in prefabricated technology with the ability to be implemented in three versions - simple, energy efficient or passive.

Minimum plot dimensions: 16mx20m
 (unless otherwise advised by zoning
 development plan or planning permission
 for a given plot)

01.hallway 2.1m²/ 02.laundry room / boiler room 1.5m²/ 03.bathroom 2.8 m²/
04.singe bedroom 8m²/ 05.single bedroom 7.4m²/ 06.kitchen 4.2m²/ 07.dining
room and living room 20,1m²/ 08.terrace 13.5m²/ 09.Double bedroom. 10.5m²